



ILAE British Branch



2020 Epilepsy Neuroimaging Course

October 8 - 10 / Chalfont
Centre for Epilepsy, UK



Location: Epilepsy Society Research Centre (ESRC) and MRI Unit, Chalfont Centre for Epilepsy
Chesham Lane, Chalfont St Peter, Gerrards Cross, SL9 0RJ

Registration site: <https://eu.eventscloud.com/neuroimaging.ilaebritish>

Day 1: Thursday 8th October 2020

13:00 - 14:00	Registration and refreshments	ESRC Atrium 1 st floor
14:00 - 14:15	Welcome & introduction - Matthias Koepp	ESRC Seminar Room
14:15 - 15:15	Lecture: MR-Physics for Epileptologists - Sjoerd Vos	ESRC Seminar Room
15:15 - 16:00	Lecture: BOLD-fMRI and resting state - Lorenzo Caciagli	ESRC Seminar Room
16:00 - 16:30	Refreshments	ESRC Atrium
16:30 - 17:15	Lecture: MRI for Epileptologists - Friedrich Woermann	ESRC Seminar Room
17:15 - 18:00	Lecture: PET for MR imagers – Matthias Koepp	ESRC Seminar Room
18:00 - 18:45	Lecture: Neuropsychology for Neuroimagers – Sallie Baxendale	ESRC Seminar Room

Day 2: Friday 9th October 2020

09:15 - 10:00	Lecture: Size of the problem - John Duncan	ESRC Seminar Room
10:00 - 11:00	Lecture: Neuroanatomy Part I - Alexander Hammers	ESRC Seminar Room
11:00 - 11:15	Refreshments	ESRC Atrium
11:15 - 12:15	Lecture: Neuroanatomy Part II - Alexander Hammers	ESRC Seminar Room
12:15 - 13:00	Lecture: Multimodal Imaging – Christian Vollmar	ESRC Seminar Room
13:00 - 14:00	Lunch	MRI Unit
14:00 - 15:00	Module 1 <ul style="list-style-type: none"> ● MRI acquisition - Andrea Hill, Lorenzo Caciagli ● Quantitative MRI - Sjoerd Vos, Marian Galovic ● Qualitative visual analysis - Christian Vollmar ● Qualitative visual analysis - Friedrich Woermann 	MRI Scanner Room MRI Physics Room MRI Fellows Room MRI Reporting Room
15:10 - 16:10	Module 2 (rotating through topics as in module 1)	
16:20 - 17:20	Module 3 (rotating through topics as in module 1)	
17:30 - 18:30	Module 4 (rotating through topics as in module 1)	
19:30	Faculty and delegate dinner	

Day 3: Saturday 10th October 2020

09:00 - 09:30	Lecture: Clinical fMRI – Meneka Sidhu	ESRC Seminar Room
09:30 - 10:00	Lecture: Language fMRI – Karin Trimmel	ESRC Seminar Room
10:00 - 10:30	Lecture: Working memory fMRI - Britta Wandschneider	ESRC Seminar Room
10:30 – 11:00	Lecture: Functional imaging / Connectomics - Silvia Bonelli	ESRC Seminar Room
11:00 – 11:30	Lecture: EEG-fMRI - Khalid Hamandi	ESRC Seminar Room
11:30 - 11:45	Refreshments	MRI Unit

11:45 - 12:45	Tutorial 1 <ul style="list-style-type: none"> • Basic fMRI – Lorenzo Caciagli • EEG fMRI - Khalid Hamandi, Maria Centeno • Multi-modal - John Duncan • Paediatric MRI – Friedrich Woermann • PET I - Alexander Hammers 	MRI Fellows Room MRI Physics Room ESRC Seminar Room MRI Reporting Room ESRC Fellows Room
12:45 - 13:45	Lunch	MRI Unit
13:45 - 14:45	Tutorial 2 <ul style="list-style-type: none"> • Advanced language fMRI – Karin Trimmel • Paediatric fMRI – Torsten Baldeweg • Big data / VBM - Marian Galovic • Multi-modal – Roman Rodionov • PET II - Alexander Hammers 	MRI Scanner Room MRI Fellows Room ESRC Seminar Room MRI Physics Room ESRC Fellows Room
14:50 - 15:50	Tutorial 3 <ul style="list-style-type: none"> • Basic fMRI – Lorenzo Caciagli • Advanced memory fMRI – Meneka Sidhu, Sarah Buck • Big data / VBM - Marian Galovic • Advanced DTI/ Tractography - Sjoerd Vos • Connectomics – Barbara Kreilkamp 	MRI Fellows Room MRI Scanner Room ESRC Seminar Room MRI Physics Room MRI Reporting Room
15:55 - 16:55	Tutorial 4 <ul style="list-style-type: none"> • Paediatric fMRI – Torsten Baldeweg • Connectomics – Barbara Kreilkamp • Advanced DTI/ Tractography - Sjoerd Vos • Multi-modal – Roman Rodionov • PET I - Alexander Hammers 	MRI Fellows Room MRI Reporting Room MRI Physics Room ESRC Seminar Room ESRC Fellows Room
17:00 - 17:30	Conclusions, quiz, feedback, end of course	ESRC Seminar Room

Contact information

If you have questions about registration, or event logistics, do contact the ILAE Event team using the information below.

Alison Cooper, Project Lead

ILAE British Branch

E: registrations@ilaebritish.org.uk

Registration site: <https://eu.eventscld.com/neuroimaging.ilaebritish>

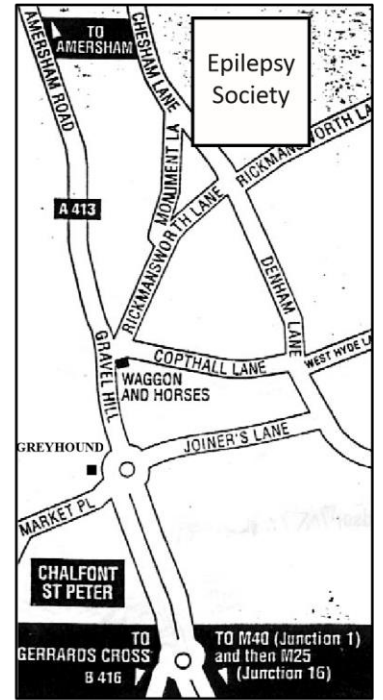
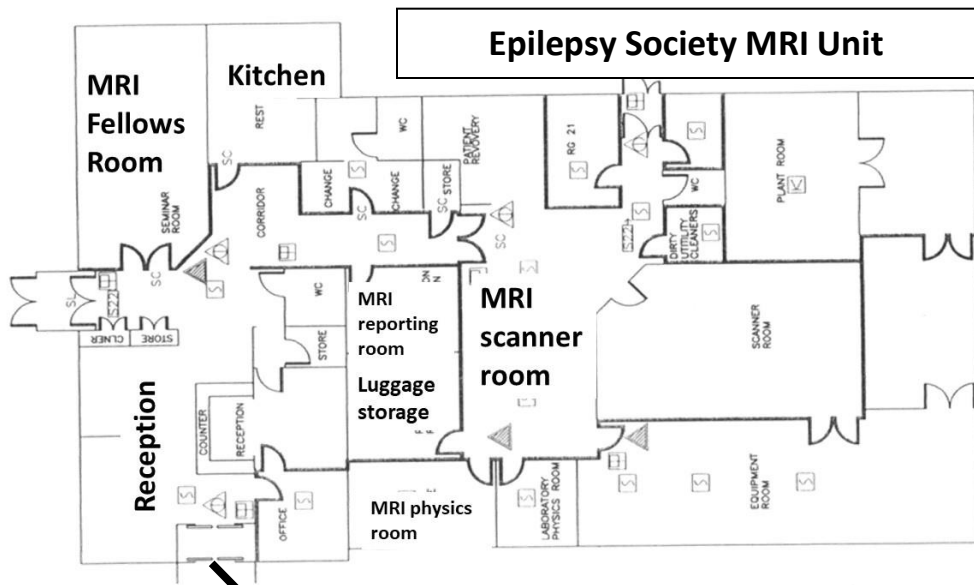

Epilepsy Society Research Centre (ESRC)

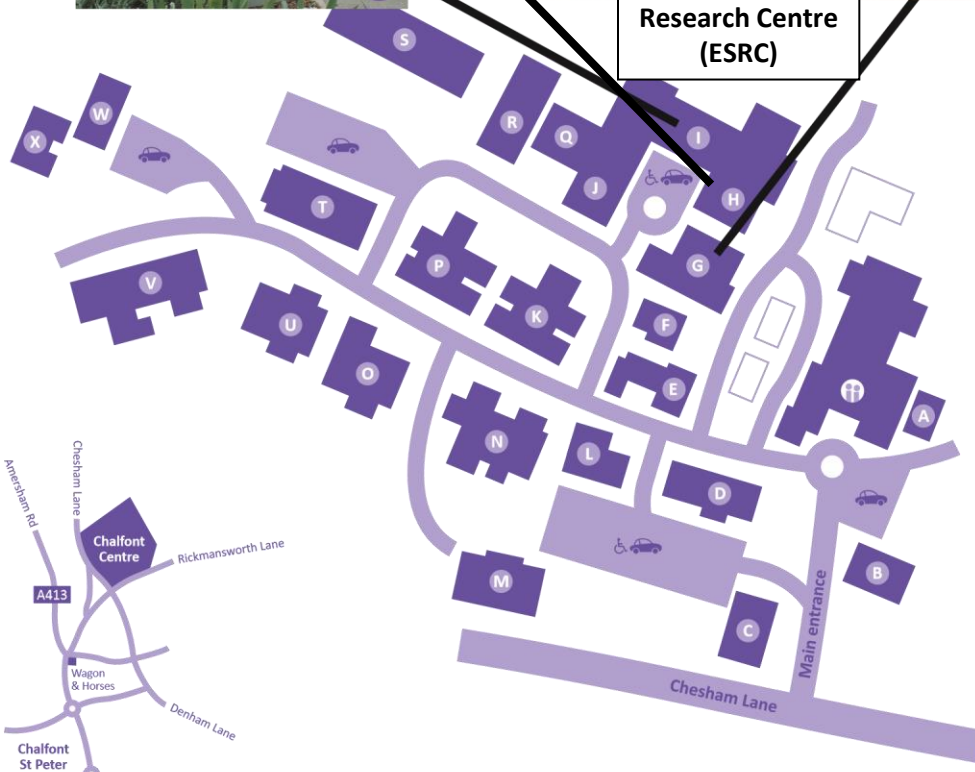

- Ⓜ Passmore Edwards House (main reception)
 - Ⓐ Personnel
 - Ⓑ Social Centre and Coffee Shop
 - Ⓒ Kent House (training)
 - Ⓓ Deamer House
 - Ⓔ Therapy Centre
 - Ⓕ Art Centre
 - Ⓖ Epilepsy Society Research Centre
 - Ⓗ M.R.I Unit
 - Ⓘ The Sir William Gowers Centre
 - Ⓝ The Queen Elizabeth Medical Centre
 - Ⓚ Pearman
 - Ⓛ Kitchener House
 - Ⓜ The New House
 - Ⓝ Micholls House
 - Ⓞ Morton House
 - Ⓟ Milton House
 - Ⓠ Queen Elizabeth House (Beech & Ash)
 - Ⓡ Queen Elizabeth House (Cedar & Willow)
 - Ⓢ Horticulture Centre
 - Ⓣ Recreation Hall
 - Ⓤ Greene House
 - Ⓥ Russell House
 - Ⓦ Information Services
 - Ⓧ Estates Department
 - 🚗 Parking 🚘 Disabled parking
- Contact details**
 T 01494 601 300
 Epilepsy Society, Chesham Lane,
 Chalfont St Peter, Buckinghamshire, SL9 0RJ



Directions are available at www.epilepsysociety.org.uk/contact